

SIZE

5, 7, 9, 12 Inch

WATT

8W, 11W, 14W, 20W, 25W

CCT

3CCT & 5CCT

DIMMABLE

TRIAC

LUMINOUS EFFICACY (Lm/W)

80 Lm/W

Beam Angle

120°

INPUT VOLTAGE

AC120V

LIFE SPAN

50,000+ Hrs

3CCT TUNABLE FLAT DISK PANEL LIGHT

TK-FDPL2™ SERIES

DESCRIPTION

schaezer® presents the Slim Flat Disk Panel Light, a sleek and efficient lighting solution from the TK-FDPL2™ series designed to provide superior illumination with a modern, unobtrusive profile.

The Slim Flat Disk Panel Light features a high-quality internal driver and Triac dimming for smooth, flicker-free operation. Rated for damp locations, it has a frosted lens, uses SMD2835 LEDs with a 120° beam angle, operates at AC120V, and offers 3CCT and 5CCT options. With a luminous efficacy of 80LM/W and a life span of over 50,000 hours, this flat LED light panel guarantees long-term performance and energy efficiency.

Ideal for lighting malls, hospitals, hotels, and retail spaces, the Slim Flat Disk Panel Light effectively replaces CFL, HID, or incandescent downlights, offering enhanced energy savings and improved aesthetics. Its wide beam angle and high lumen output ensure bright and even illumination, making it suitable for various commercial and residential applications.

The Slim Flat Disk Panel Light comes with a 5-year limited warranty, ensuring reliable operation and customer satisfaction. This product meets high standards of quality and performance, making it a dependable choice for modern lighting needs.



3CCT TUNABLE FLAT DISK PANEL LIGHT

TK-FDPL2 SERIES

Applications

Ideal for lighting malls, hospitals, hotels, and retail spaces. Replaces CFL & HID or Incandescent downlights for higher energy savings & aesthetics

Quick Ship:

TK-FDPL2-5-8W-3CCT	TK-FDPL2-5-8W-5CCT
TK-FDPL2-5-11W-3CCT	TK-FDPL2-5-11W-5CCT
TK-FDPL2-7-14W-3CCT	TK-FDPL2-7-14W-5CCT
TK-FDPL2-9-20W-3CCT	TK-FDPL2-9-20W-5CCT
TK-FDPL2-12-25W-3CCT	TK-FDPL2-12-25W-5CCT

Controls / Dimming

High quality internal driver; Triac dimming; Flicker free. Frosted Lens and Non-IC, and rated for damp locations. SMD2835. Beam angle is 120°.

Warranty

5 Years Limited Warranty.

Installation / Mounting

The installation process is straight forward and offers a range of mounting possibilities. LED downlight retrofit is supplied with a quick connect-case and conduit to make an easy connection to an existing recessed fixture frame junction box

Ordering Information

Example: TK-FDPL2-5-8W-3CCT

TK	FDPL2	5	8W	3CCT	[BLANK]	Optional
<input type="text"/>	<input type="text"/>	<input type="text"/>	<input type="text"/>	<input type="text"/>	<input type="text"/>	<input type="text"/>
Code	Series	Diameter	Watts	Color Temp	Dimming D - Dimming Triac	Mounting
TK	FDPL2 - Flat Disk Panel Light Gen 2	5"- 5 inch 7"- 7 inch 9"- 9 inch 12"-12 inch	8W - 8 Watts 11W- 11 Watts 14W - 14 Watts 20W - 20 Watts 25W - 25 Watts	30K - 3000K 3CCT - 40K - 4000K 50K - 5000K 27K - 2700K 30K - 3000K 5CCT - 35K - 3500K 40K - 4000K 50K - 5000K	Voltage AC120V Beam Angle Beam Angle 120°	Surface Mounting Retrofit Mounting

3CCT TUNABLE FLAT DISK PANEL LIGHT

TK-FDPL2 SERIES

Dimension

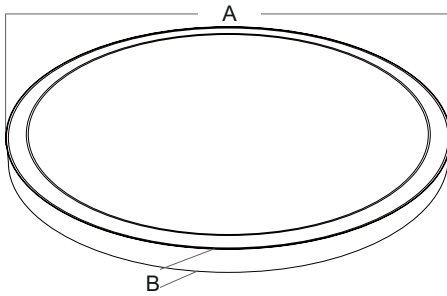

Part Number	A (Diameter)	B (Height)
TK-FDPL2-5	5 inches	0.6 inches
TK-FDPL2-7	7 inches	
TK-FDPL2-9	9 inches	
TK-FDPL2-12	12 inches	

Infographics

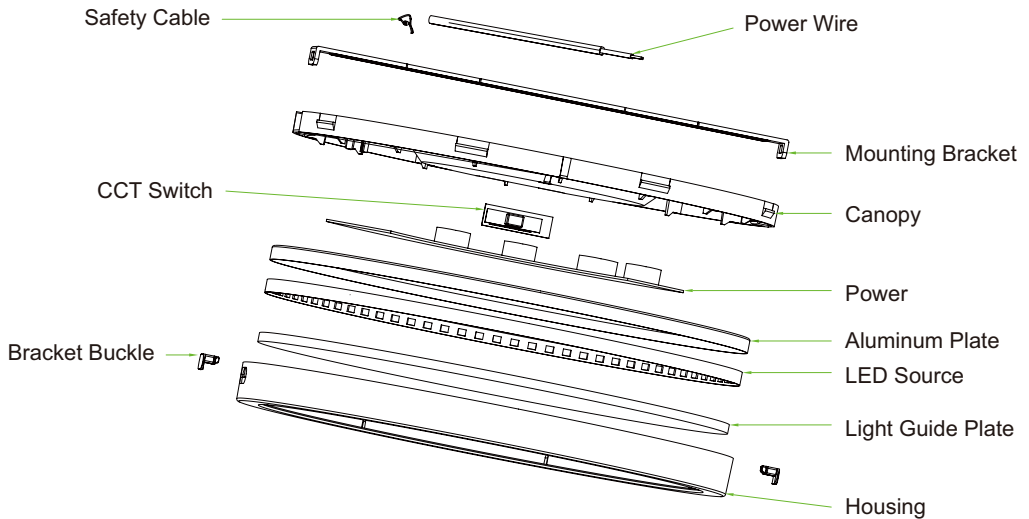

Photometrics

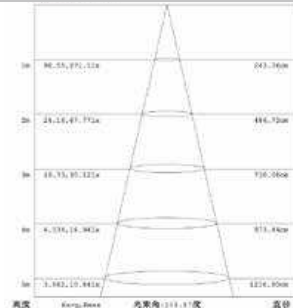
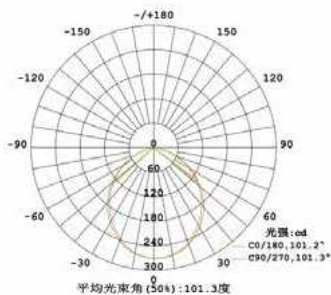

3CCT TUNABLE FLAT DISK PANEL LIGHT

TK-FDPL2 SERIES

Installation

Important Safety Instructions

- To avoid electric shock, maintenance and installation should only be carried out by a professional electrician
- Before installation, turn off the power to make sure safety
- Follow the diagram for below for proper installation

Warning

- Handle product with care.
- Please use it under correct input power range.
- Do not use in the outdoor environment.
- Consult with the manufacturer before maintenance.
- If the product does not operate properly, check the wire connection after the power cut off.

EMBEDED IN INSTALLATION

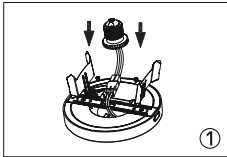

Remove trim and existing lamp from recessed fixture;

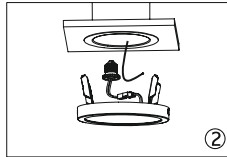

Screw E26 socket adapter into socket in the housing;

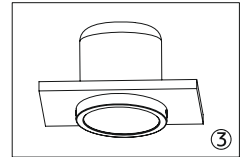

Press the friction blade to insert the lamp into the housing and restore power.

SURFACE MOUNTING INSTALLATION

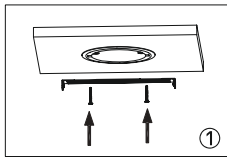

Fixing bracket on terminal box;

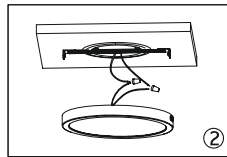

Connecting the wire;

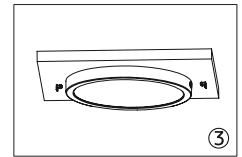

Fixing the lamp body on bracket and fix tightly.