



WATT
40W / 60W / 75W
CCT
3000K, 4000K, 5000K
DIMMABLE
0 -10V
CRI
70+
LUMINOUS EFFICACY (Lm/W)
135 Lm/W
INPUT VOLTAGE
120-277VAC / 120 - 347VAC
IP RATING
Ip65
Operating Temperature
30°C ~ 50°C
LIFE SPAN
50,000+ Hrs



LED GARAGE CANOPY LIGHT

TK-CP02G™ SERIES

DESCRIPTION

schaezer® presents the LED Garage Canopy Light, a robust and energy-efficient solution designed to excel in various environments. Crafted with a sturdy die-cast aluminum housing, this fixture guarantees durability and reliability under challenging conditions. Featuring 0-10V dimming and adjustable 3CCT and wattage settings, it offers versatile lighting options tailored to specific needs. Operating on 120-277VAC or 120-347VAC, it achieves an impressive luminous efficacy of 135 Lm/W across 3000K, 4000K, and 5000K color temperature options, with a high color rendering index (CRI) of 70+ for clear visibility.

Ideal for enhancing safety and visibility in parking garages, canopies, storage areas, gas stations, and walkways, the LED Garage Canopy Light delivers reliable performance and energy efficiency. Its IP65 rating ensures resistance to dust and water, making it suitable for outdoor applications. Whether for residential or commercial use, this fixture provides superior illumination and durability.

Backed by a 5-year limited warranty and compliant with IP65 standards, the LED Garage Canopy Light meets rigorous industry requirements for quality and safety assurance. Enhance your environment with the reliability and efficiency of Schaezer's LED canopy lights, perfect for illuminating canopies and enhancing safety in various outdoor settings.



LED GARAGE CANOPY LIGHT

TK-CP02G SERIES

Applications

Ideal for Parking garages, Canopies, Storage areas, Outdoor aisles, Gas stations, Walkways, Entryways, Etc.

Quick Ship:

TK-CP02G-40W/60W75W-3CCT

Controls / Dimming

0-10V Dimming. Durable die cast aluminum housing for long-lasting use. 3CCT & wattages can be adjusted in the field per your needs.

Warranty

5 Years Limited Warranty

Installation / Mounting

The installation process is straight forward and offers a range of mounting possibilities and wired via conduit entries. Surface mounting and Pendant Mount optional.

Ordering Information

Example: TK-CP02G-40W-3CCT

TK	CP02G	40W	3CCT	[BLANK]	Optional
<input type="text"/>	<input type="text"/>	<input type="text"/>	<input type="text"/>	<input type="text"/>	<input type="text"/>
Code TK	Series CP02G - Canopy Light Gen 2	Watts (Wattage Selectable) 40W or 20W/30W/40W 55W or 30W/40W/55W 60W or 30W/40W/60W 70W or 40W/60W/70W 75W or 40W/60W/75W	Color Temp 3CCT Selectable 30K - 3500K 40K - 4000K 50K - 5000K 3000K - 6500K (single color temperature optional)	Dimmable D- 0-10V Dimming Voltage V-120-277VAC 120-347VAC	[BLANK] PIR Sensor Microwave Motion Sensor Bluetooth Motion Sensor Finishes Black, White, Bronze

LED GARAGE CANOPY LIGHT

TK-CP02G SERIES

Dimension

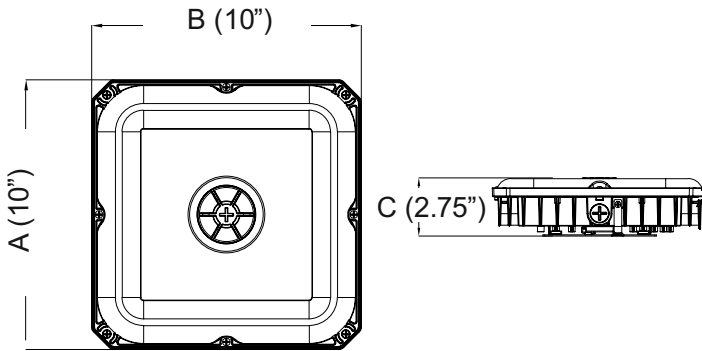

Part Number	A (Length)	B (Width)	C (Height)
TK-CP02G-XXW	10 Inches	10 Inches	9.45 Inches

Appearance



LED GARAGE CANOPY LIGHT

TK-CP02G SERIES

Installation Guide

Warning

THE LED GARAGE CANOPY MUST BE INSTALLED IN ACCORDANCE WITH ALL APPLICABLE ELECTRICAL CODES BY PERSONS FAMILIAR WITH THE INSTALLATION, OPERATION, AND/OR MAINTENANCE OF THE PRODUCTS AND THE HAZARDS INVOLVED. THE LED GARAGE CANOPY MUST BE INSTALLED WITH UL LISTED CONDUIT FITTINGS.

1. Risk of fire or electric shock.

1-1 Make sure the working voltage of LED Garage Canopy is under its rated voltage.

1-2 Make sure the accessories and wires are completed and intact during the installation.

1-3 Installation requires knowledge of electrical systems. For install by qualified electrician only.

Do not attempt installation if not qualified.

1-4 This fixture should only be installed in place of existing luminaries that have the construction features and dimensions specified in this manual.

2. DO not expose any wire to edge of sheet metal and/or other sharp objects that may cause damage or abrasion.

3. Do not change existing open holes or create any additional open holes in the fixture or its components during installation.

Caution

1. Be certain electrical power is OFF before and during installation and maintenance.

2. To prevent wiring damage or abrasion, do not expose wiring to edges of sheet metal or other sharp objects.

3. Do not use the LED Garage Canopy near heating appliances/ elements.

4. The input voltage and lamps should be matched after connecting the power line, please make sure the wiring section is insulated.

LED Garage Canopy must be operated within an ambient temperature range of -220F to 1220F (-300C to + 500C). LED Garage Canopy is not intended for use with emergency exits.

LED GARAGE CANOPY LIGHT

TK-CP02G SERIES

Installation Method

Installation method I: Pole-pendant Installation

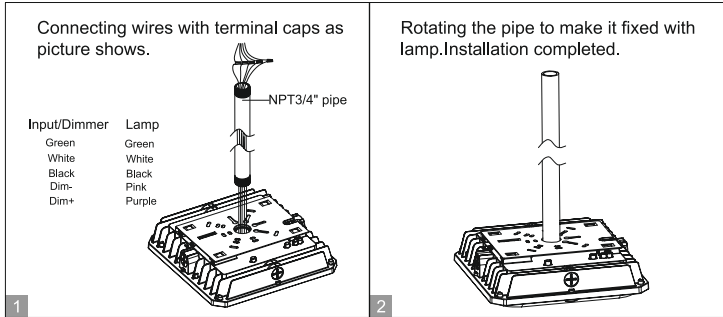

Installation method 11: Ceiling Installation

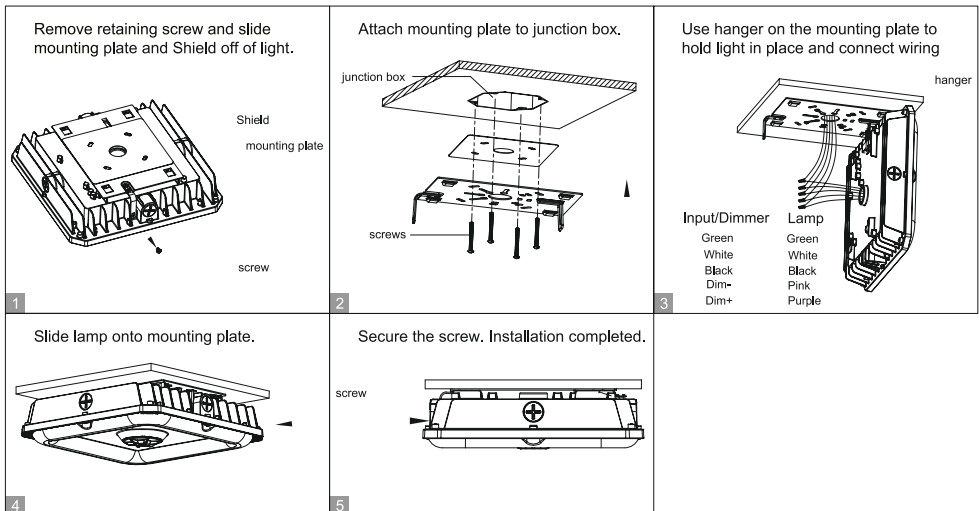

LED GARAGE CANOPY LIGHT

TK-CP02G SERIES

Installation Method

Selectable CCT and wattage function installation

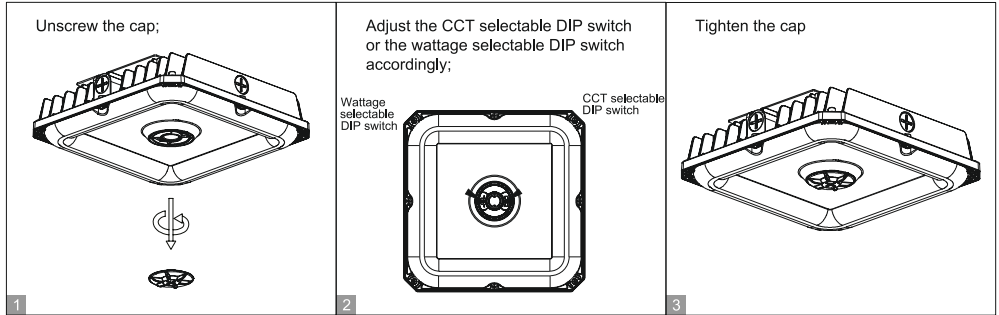

Sensing function installation

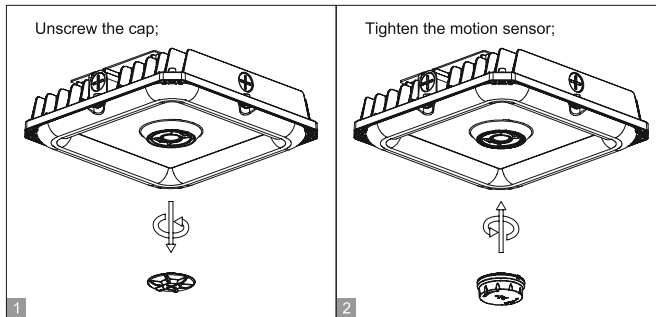

*The Installation must be carried out by a qualified electrician.